

# DSI Round Column

## Installation Instructions



- |   |  |
|---|--|
| <ul style="list-style-type: none"><li>• DSI round columns are load bearing columns.</li><li>• Staves snap together to form a column.</li><li>• NOTE: Always check local building codes before installing columns.</li></ul> | <ul style="list-style-type: none"><li>• <u>Tools needed:</u><ul style="list-style-type: none"><li>◦ Chop saw with non-ferrous metal blade</li><li>◦ Cordless screw gun</li><li>◦ #2 square head bit</li><li>◦ Level</li><li>◦ Touch up paint</li></ul></li></ul> |
|---|--|

**Step 1** Measure height of opening where column is to be located. Cut all staves to length with nonferrous metal blade in chop saw. All three (3) staves must be cut the same length.

- Note: Cut staves  $\frac{1}{4}$ " taller than opening for load bearing application.

**Step 2** Notice the ends of the stave. Hinge the narrow opening of one stave into the wide opening of the other stave. Hinge the last stave the same way and snap the column together. Tap lightly with a rubber mallet if necessary. (See Fig.1)

- Note: When installing column on treated wood surfaces, raw column ends must be painted to provide a barrier between aluminum column and treated wood surface.

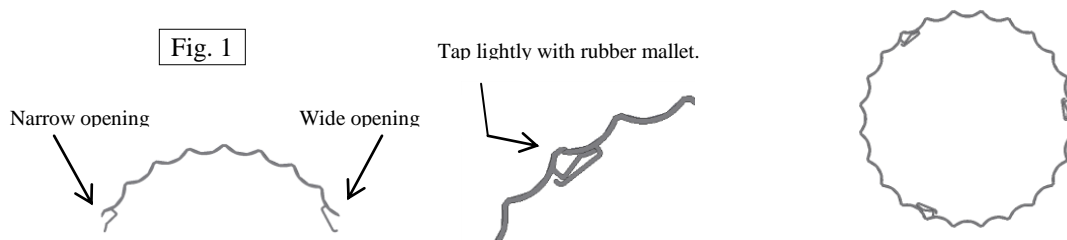

**Step 3** Slide capital and base onto column being careful not to scratch the painted surface. Capital and base may be secured away from each end with masking tape. (See Fig. 2)



**Step 4** Raise header, position the column in place, and center load onto column to ensure even distribution on each side of column.

- Note: Install on a smooth and level surface.

**Step 5** Locate eight (8) angle brackets at the top and bottom of the column. (See Fig. 3) Use screws provided to attach angle brackets to column. Use appropriate fasteners to attach angle brackets to mounting surface (not included).

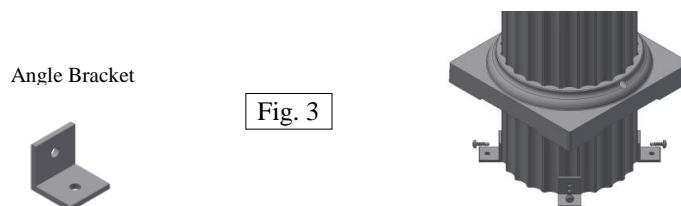

# DSI Round Column

## Installation Instructions



**Step 6** Slide base to bottom of column and insert 2 screws into base as shown. (See Fig. 4) Repeat for capital at the top of column.

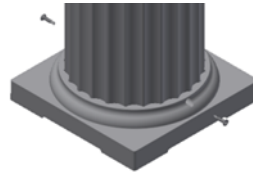

Fig. 4

Note: 6" and 8" diameter round columns up to 10' long include capital (1pc), base (1pc) and angle brackets (8 pack) in column boxes.

All other round column sizes will require capital, base and angle brackets to be ordered separately.

Best installation practice is to remove existing supports and replace with these columns.

6" column will wrap around a 3½" sq. or a 4½" diameter round post.

8" column will wrap around a 4½" sq. or a 6¼" diameter round post

» If using other DSI mounting hardware please follow instructions specific to those products. «